

Edwards EVEN-FLOW CIRCULATORS

Featuring

- LARGE VOLUME FLOW AT MODERATE HEADS
- LOW BEARING TEMPERATURES
- IDEAL FOR HOT WATER OR CHILLED WATER APPLICATIONS
- STAINLESS STEEL IMPELLER
- HARDENED STAINLESS STEEL SHAFT
- WEBBED BEARING SUPPORT
- ISOLATED BEARING HOUSING
- FLEXIBLE COUPLING

3" Pipe Size; ½ HP; up to 100 gpm.

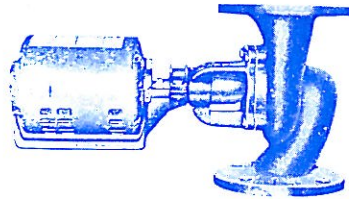

MODELS: 340-17

FORM 10-CRP-21
Effective Nov. 1, 1990

1¼"x1½"; 2x2 Pipe sizes; ½ to ½ HP; up to 100 gpm.

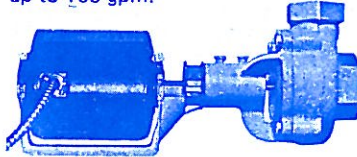

MODELS:
140-17 (Parkway); A140, A240, A340-17

1¼" Pipe Size; ½ HP; up to 59.0 gpm.

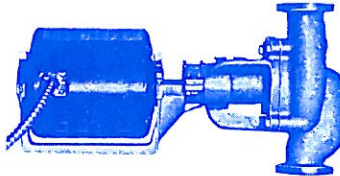

MODELS: 140-17; 240-17; 140B-17 (BRONZE)

3", 4" and 6" Pipe Size;
1 to 10 HP; 178 to 700 gpm.

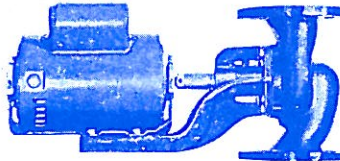

MODELS:
350, 360-17; 450, 460-17; 670, 680-17;
330, 335, 340-34; 360B-17 (BRONZE)**

CIRCULATORS TRADE PRICES

f.o.b. Pompton Plains, New Jersey

1¼"x1½"; 2x2 Pipe Sizes; ½ to 3 HP; up to 190 gpm.

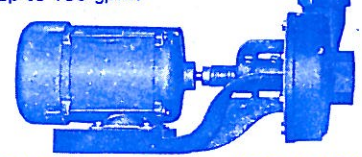

MODELS: A260-17; A130, A135, A140-34; A230, A235, A240-34; A330, A335, A340-34

1¼" Pipe Size; ½ to 1½ HP; up to 114 gpm.

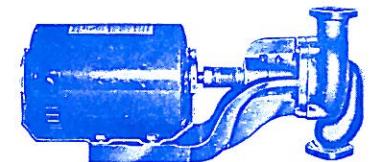

MODELS: 130, 135, 140-34; 230, 235, 240-34

2", 3" and 4" Pipe Size;
1 to 3 HP; up to 475 gpm.

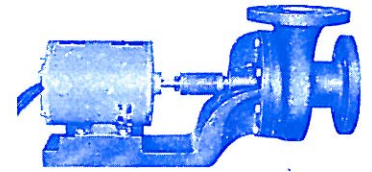

MODELS: A350, A360-17; A450, A460-17; A260B-17 (BRONZE)**

HALE ENGINEERING COMPANY, INC.
100 NORTH GORDON STREET
ELK GROVE VILLAGE, IL 60007-1193
TELEPHONE (708) 956-1600
FAX (708) 956-0595

1725 RPM
CIRCULATORS FOR
HEATING/COOLING
APPLICATIONS

3450 RPM
CIRCULATORS FOR
INDUSTRIAL
APPLICATIONS
ONLY

CIRCULATOR MODELS		OPTIONAL IMPELLERS	STANDARD MOTOR, (H.P.)	WEIGHT, (Lbs.)	PIPE SIZES, (In.)		TRADE PRICES*
Flanged	Threaded				Flanged	Threaded	
—	140-17-½ (Pkwy)	—	½	22	—	1¼x1½	
140-17-½	A140-17-½	130;135	½	25	1¼	1¼x1½	
140B-17-½ (Brnz)	—	—	½	27½	1¼	—	
240-17-½	A240-17-½	230;235	½	35	1¼	1¼x1½	
—	A260-17-1	—	1	47	—	2x2	
240-17-½	A240-17-½	230;235	½	45	1¼	1¼x1½	
A260B-17-1 (Brnz)	—	—	1	58	2	2x2	
340-17-½	A340-17-½	330;335	½	47½	3	—	
340-17-½	A340-17-½	330;335	½	77½	3	2x2	
350-17-1; A350	—	—	1	68	3;3	—	
360-17-2; A360	—	—	2	108	3;3	—	
360B-17-2 (Brnz)*	—	—	2	123	3	—	
450-17-2; A450	—	—	2	138	4;4	—	
460-17-3; A460	—	—	3	139	4;4	—	
670-17-½	—	—	7½	281	6	—	
680-17-10	—	—	10	364	6	—	
130-34-¾	A130-34-¾	—	½	40	1¼	1¼x1½	
135-34-¾	A135-34-¾	—	¾	35	1¼	1¼x1½	
140-34-1	A140-34-1	—	1	42	1¼	1¼x1½	
230-34-¾	A230-34-¾	—	¾	43	1¼	1¼x1½	
235-34-1	A235-34-1	—	1	45	1¼	1¼x1½	
240-34-1½	A240-34-1½	—	1½	47	1¼	1¼x1½	
330-34-1	A330-34-1	—	1	49	3	2x2	
335-34-1½	A335-34-1½	—	1½	60	3	2x2	
340-34-2	A340-34-2	—	2	67	3	2x2	

Prices F.O.B. Pompton Plains, N.J. Unless specified otherwise, material is shipped freight collect. Manufacturer retains the right to change prices, design, and materials without notice.

*Prices listed for standard motors; optional motors available. Consult factory for prices.

**Bronze Impeller Housing; Cast Iron Bearing Assembly.

Products of:



Edwards ENGINEERING CORP.

101 ALEXANDER AVENUE, POMPTON PLAINS, NJ 07444
PH: (201) 835-2800 FAX: (201) 835-3222 TELEX: 130-131

OVER

INSTALLATION AND PARTS

Edwards Even-Flow Circulators

INSTALLATION

Edwards Even-Flow Circulators are available with pipe flange connections (sizes noted in listings), and may be installed for either vertical or horizontal water flow. Circulators shipped from the factory are assembled for vertical installation; horizontal installation can be

obtained by unbolting the impeller housing, rotating the housing 90° and rebolting. Note: The electric motor should be maintained in a horizontal position at all times with oil openings on top.

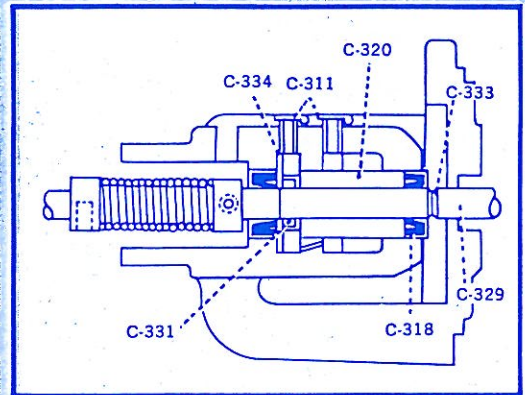
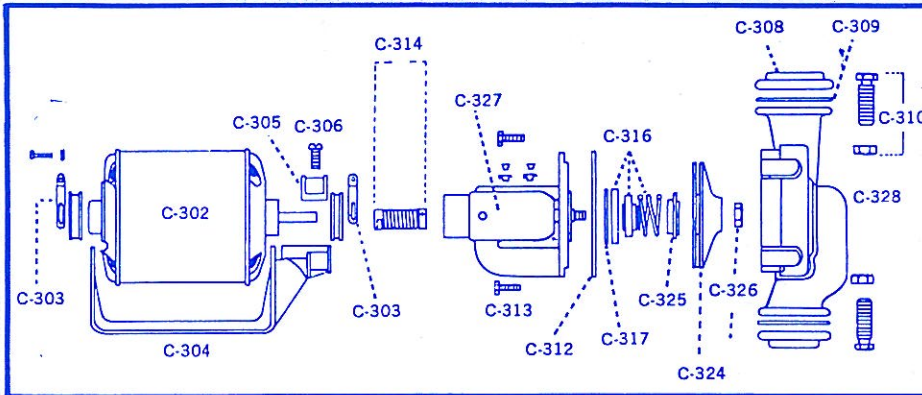

TABLE OF PARTS

Part No.	Description	Part No.	Description
* C-300	Circulator, less motor	C-317	Washer, Water Seal
C-302	Motor, Circulator	C-318	Seal, Oil External, Steel (2 required)
C-303	Latches, Motor (2 required)	C-320	Bearing
C-304	Bracket, Motor	C-321	Decal, Rating Instructions
C-305	Clamp, Bracket	* C-322	Housing Assembly, Shaft w/Impeller (Repair Kit)
C-306	Clamp w/hardware	C-324	Impeller Assembly only
C-307	Flanges, w/Gaskets & Hardware	C-325	Hub, Impeller
C-308	Flanges Only (2 required)	C-326	Nut, Impeller
C-309	Gasket, Flange (2 required)	C-327	Housing, Shaft, w/Oil Hole Cover
C-310	Hardware for Flanges	* C-328	Housing, Impeller
C-311	Cover, Oil Hole	C-329	Shaft Only
C-312	Gasket, Housing	* C-330	Shaft w/Thrust Washer & Retaining Ring Mounted
C-313	Hardware, Housing	C-331	Washer, Thrust, w/Insert
C-314	Coupling, Spring, w/Set Screws	C-333	"O" Ring
C-316	Water Seal Assembly	C-334	Retaining Ring
		* Refer to Parts Price List for complete designation by circulator model number.	

WARRANTY (Limited)

The manufacturer warrants to the dealer the products described herein to be free of original defects in material and workmanship, and will, within one year from the date of factory shipment, repair or replace, at its option, F.O.B. factory, any parts which upon inspection at its factory are found to be defective. Any such defective parts are to be returned through the dealer from whom purchased, transportation charges prepaid. The manufacturer shall not be liable for any charges involved in the removal or replacement of material at the point of operation, or for any damages which anyone may allege to have

suffered as a result of any defect. The manufacturer's liability is limited to repair or replace as aforesaid, and is further limited to the dealer. The manufacturer makes no guaranty or warranty of any kind, express or implied, to any other person. This warranty negates all warranties and conditions implied by any applicable statutes or rules of law. A competent service organization must be engaged by owner to maintain the equipment. The manufacturer retains the right to change prices, design, and material without notice. (W-2)

Products of:



Edwards ENGINEERING CORP.

101 ALEXANDER AVENUE, POMPTON PLAINS, NJ 07444
PH: (201) 835-2800 FAX: (201) 835-3222 TELEX: 130-131

For further information:

HALE ENGINEERING COMPANY, INC.
100 NORTH GORDON STREET
ELK GROVE VILLAGE, IL 60007-1193
TELEPHONE (708) 956-1600
FAX (708) 956-0595

847